

# Section 26

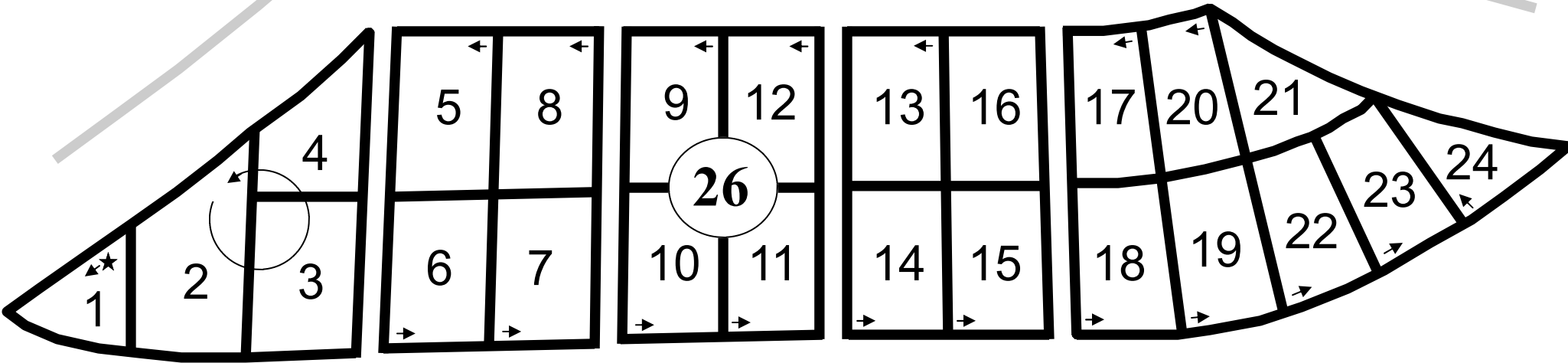
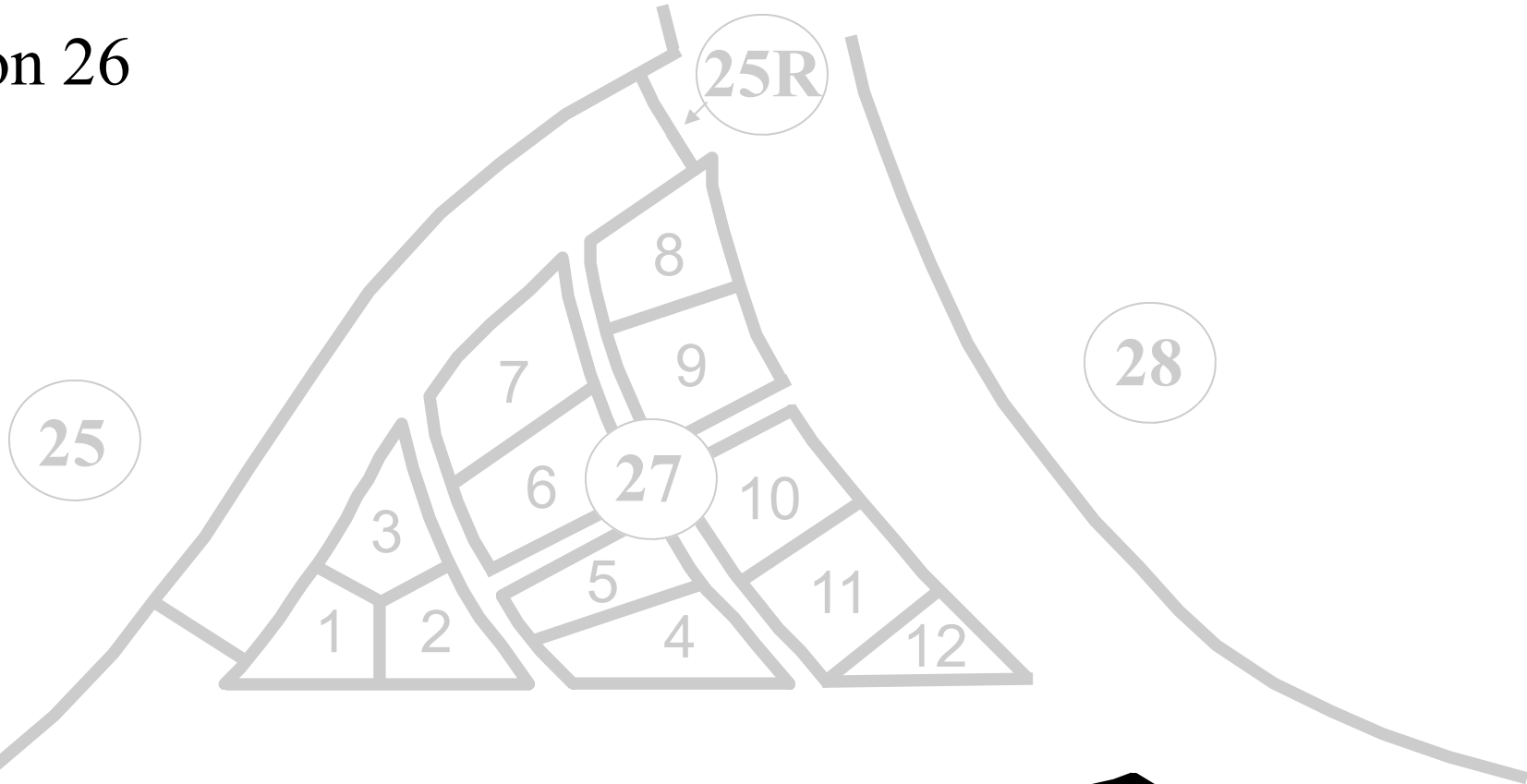

- ★ Start of Section transcription
- ➔ Start and direction of Lot transcription

Section 26  
Family Lots

	FAMILY	ACQUIRED BY	DATE
Lots 1, 2, 3 & 4	Power	Abram L. Power	May 10, 1889
Lot 5	Walker	n/a	n/a
Lot 6	Tiffin	C. H. Tiffin	Feb. 13, 1893
Lot 7	Larkins	Florence Larkins	Mar. 19, 1910
Lot 8	Larkins	Hattie Larkins	Nov. 20, 1907
Lot 9	Clark	Spencer Clark	Feb. 5, 1889
Lot 10	Smith	M. L. Smith	Nov. 6, 1914
Lot 11	Fuller	Albert E. Fuller	Apr. 13, 1914
Lot 12	Withee	Mrs. J. M. Withee	bef. Sept. 27, 1886
Lot 13 North	Withee	Milton J. Withee	Jan. 5, [1891] <sup>1</sup>
Lot 13 South	Robinson	E. J. Robinson	Mar. 30, 1896
Lot 14	VanSickle	Charles H. Coldren <sup>2</sup>	July 10, 1915
Lot 15	Miller	Marie C. & Louis Miller	Oct. 23, 1914
Lot 16 West	Coldren	O. B. Coldren <sup>3</sup>	Dec. 18, 1900 <sup>4</sup>
Lot 16	Simmons	Arthur J. Simmons	Oct. 19, 1915
Lot 17	Griswold	n/a	n/a
Lot 18	Strachan	Ethel W. Franklin <sup>5</sup>	May 22, 1916
Lot 19	Wilson	n/a	n/a
Lot 20	Lewis	n/a	n/a
Lot 21	n/a	n/a	n/a
Lot 22	Leadbeter	Andrew Leadbeater [sic]	Oct. 12, 1921
Lot 23	Willis	n/a	n/a
Lot 24 <sup>6</sup>	Batt	Wm Phillips <sup>7</sup>	Apr. 28, 1923

<sup>1</sup> year not recorded, but inferred from its chronological entry in the City's Register of Deeds

<sup>2</sup> lot was originally purchased for Charles Coldren's son-in-law, Harrison B. Noble, who died on May 9, 1915 and is now currently interred in the Mausoleum with his wife and her parents; the lot was assigned to H. M. VanSickle on June 30, 1927; on June 17, 1935, the lot was divided between Mrs. Nettie VanSickle (north half) and Mrs. Phoebe Heintz (south half)

<sup>3</sup> the west half of this lot was originally purchased for Osmund B. Coldren's daughter, Letha B. Coldren, who died on Dec. 17, 1900; the Coldren family is now buried in Sec 30

<sup>4</sup> date also recorded as Mar. 29, 1907

<sup>5</sup> lot was originally purchased for Ethel Franklin's son, Harold A. Franklin, who died on Mar. 11, 1916; per FindAGrave, he is now buried with his parents in Hillcrest Memorial Gardens in Owosso, MI; no record of when the lot was transferred to the Strachans

<sup>6</sup> per City's Register of Deeds, Wm Phillips acquired Lot 21 (probably an error in recording)

<sup>7</sup> lot transferred to Vivian H. Batt on July 18, 1936

## Section 26

### Lot 1

BONGIOVANNI	Mary <i>HAMLIN</i>	"Wife, Mother, Grandma", May 7, 1935 - July 12, 2019
BONGIOVANNI	Eugene	"Husband, Father, Grandpa", Jan. 2, 1934 - ? (d. Apr. 23, 2021)
HOLMAN	Catherine B. BONGIOVANNI	Feb. 12, 1916 - July 1, 2007
HOLMAN	Clarence J.	Tec 5 U.S. Army, WW II, "Married 58 years", Sept. 30, 1912 - Feb. 16, 2000 (d. in Livonia, Wayne Co., MI) (also has a marker in Veterans Section)

### Lots 2, 3 & 4

POWER	David B.	Mason, Age 31y, 12d, d. Nov. 1873 (d. Nov. 7, 1873 in Lyons, Ionia Co., MI)
POWER	M. L. P.	No Dates, footstone
POWER	Ira	Age 59y, 9m, 18d, d. Sept. 21, 1858
POWER	Amy L. <i>LAPHAM</i>	"w/o Ira", Age 89y, 27d, d. Feb. 29, 1892 (d. in Novi, Oakland Co., MI)
POWER	Amy Lucina	Age 25y, 2m, 14d, d. Dec. 28, 1857
POWER	Mary Lavina	Age 20y, 12d, d. Jan. 12, 1858
unknown	unknown	broken stone
POWER	Ira Jr.	"s/o Ira & Amy", Age 18y, 29d, d. June 18, 1853
POWER	Arthur D.	"Father", 1827 - 1892 (d. Jan. 13, 1892 in Livonia)
POWER	Maria H. <i>HART</i>	"His Wife, Mother", 1828 - 1895 (d. Dec. 5, 1895 in Livonia)
POWER	Isaac H.	"s/o Arthur D. & Maria H.", Apr. 12, 1865 - Oct. 6, 1865
POWER	Mary <i>Hart</i>	1854 - 1937 (d. Apr. 27, 1937 in Farmington, Oakland Co., MI)
POWER	Harriet K. <i>KLAVITTER</i>	1895 - 1948 (d. Nov. 1, 1948 in Novi, Oakland Co., MI)
POWER	Arthur S.	1891 - 1958 (d. Aug. 15, 1958 in Detroit)
POWER	Orpha M. <i>SMITH</i>	"w/o A. L.", 1847 - 1890
POWER	Eva	"d/o -----", Mar. 5, 1877 - Aug. 31, 1877 (d. in Farmington, Oakland Co., MI)
POWER	Marion N.	1897 - 1981 (d. July 28, 1981 in Trenton, Wayne Co., MI)
GOW	Hester <i>POWER</i>	1896 - 1982 (d. Oct. 10, 1982 in Trenton, Wayne Co., MI)

### Lot 6

#### Row 1

Van VALKENBURG	Franklin W.	Mich. Sgt. Co. B., 40 Machine Gun Bn. WW I, Apr. 2, 1896 - Jan. 14, 1959 (d. in Ann Arbor, MI)
TIFFIN	Charles H.	Mason, Shriner, 1854 - 1921 (d. Dec. 25, 1921 in Northville)
TIFFIN	Earl	1891 - 1893 (d. Sept. 2, 1893 in Plymouth)

#### Row 2

Van VALKENBURG	Ermah TIFFIN	No Marker (d. Feb. 6, 1987 in Chelsea, Washtenaw Co., MI at age 92)
----------------	--------------	---

### Lot 7

#### Row 1

LARKINS	Peter	1843 - 1910 (d. Mar. 17, 1910 in Salem Twp, Washtenaw Co., MI)
LARKINS	Florence A. M. <i>LOCKWOOD</i>	1853 - 1932 (d. Sept. 18, 1932 in Northville)
LaFORTE	Ann T. <i>TOBEY</i>	Aug. 7, 1922 - Jan. 20, 1990 (d. in Westland, Wayne Co., MI)
LaFORTE	Freemont E.	Tec 4, U.S. Army WW II, Jan. 17, 1918 - Mar. 12, 1976 (d. in Petosky, Emmet Co., MI)

## Section 26

### Lot 7 (continued)

#### Row 2

LARKINS	Zenaide E. <i>MERRITT</i>	1884 - 1980 (d. Apr. 18, 1980 in Livonia)
LARKINS	Royal B.	1877 - 1956 (d. Mar. 30, 1956 in Northville)
TOBEY	Margaret C. <i>CHADWICK</i>	Dec. 17, 1894 - July 2, 1979 (d. in Midland, Midland Co., MI)
TOBEY	Thomas J.	Mar. 30, 1892 - Oct. 12, 1959

### Lot 10

SMITH	Edgar M.	1872 - 1944 (d. Sept. 7, 1944 in Northville)
SMITH	Martha M. <i>WARREN</i>	1843 - 1922 (d. Jan. 23, 1922 in Northville)
SMITH	Martin L.	1841 - 1919 (d. Apr. 9, 1919 in Northville)

### Lot 11

#### Row 1

FULLER	Howard W.	1898 - 1973 (d. Aug. 17, 1973 in Farmington Hills, Oakland Co., MI)
FULLER	Margaret T. <i>LENZ</i>	1900 - 1989 (d. June 9, 1989 in Westland, Wayne Co., MI)

#### Row 2

FULLER	Alfred E.	1873 - 1939 (d. Mar. 11, 1939 in Saline Twp, Washtenaw Co., MI)
FULLER	Ermina E. <i>LARGE</i>	1874 - 1943 (d. Jan. 23, 1943 in Northville)
CARR	Josephine <i>ELLIOTT</i>	1853 - 1939 (d. Nov. 1, 1939 in Northville)

### Lot 14

#### Row 1

Van SICKLE	Nadine <i>Marguerite</i>	1949 - 1950 (d. Apr. 21, 1950 in Plymouth) (cement marker)
Van SICKLE	Nettie S. <i>VRADENBURG</i>	1858 - 1938 (d. Mar. 7, 1938 in Northville)
Van SICKLE	Henry M.	1858 - 1935 (d. Apr. 25, 1935 in Northville)

#### Row 2

BURKHART	Betty Jean HEINTZ	No Marker (d. Mar. 14, 2010 at age 78)
HEINTZ	Phoebe A. <i>Van SICKLE</i>	"Mother", July 19, 1900 - Aug. 18, 1965 (d. in Livonia, Wayne Co., MI)
HEINTZ	Frank Sr.	Mich. Pvt, Co. K., Casual Det WW I, Oct. 24, 1893 - July 8, 1959 (d. in Ann Arbor, MI)

### Lot 15

#### Row 1

HOCHKINS	Elizabeth ( <i>Betty</i> ) <i>LANNING</i>	May 6, 1922 - June 1, 1997 (d. in Livonia, Wayne Co., MI)
----------	--	---

HOCHKINS	John	Dec. 19, 1921 - Dec. 14, 1992 (d. in Livonia, Wayne Co., MI)
ASHLEY	Marie MILLER ( <i>nee KREAGER</i> )	1886 - 1945 (d. Jan. 12, 1945 in Dundee, Monroe Co., MI)

MILLER	Henry C.	1878 - 1914 (d. Oct. 16, 1914 in Novi Twp, Oakland Co., MI)
--------	----------	---

#### Row 2

MILLER	Mary <i>BROCKMILLER</i>	"Mother", 1854 - 1910 (d. May 11, 1910 in Novi Twp, Oakland Co., MI)
--------	-------------------------	--

### Easement

KENNER	Constance Lee	Nov. 2, 1944 - Nov. 5, 1995 (d. in Garden City, Wayne Co., MI)
--------	---------------	--

## Section 26

**Lot 18**

STRACHAN STRACHAN STRACHAN STRACHAN	Alexander Jr. Alexander Bella <i>RITCHIE</i> Earl	"Son", 1921 - 1969 (d. Sept. 23, 1969 in Ann Arbor, MI) "Father", 1885 - 1965 (d. July 15, 1965 in Northville) "Mother", 1898 - 1927 (d. Apr. 28, 1927 in Northville) "Son", 1923 - 1927 (d. May 5, 1927 in Ann Arbor, MI)
--	--	---

**Lot 19**

BUTLER BUTLER WILSON WILSON	Frank D. Laura C. <i>WILSON</i> <i>Evaline OUDERKIRK</i> Robert H.	1860 - 1938 (d. Feb. 17, 1938 in Northville) 1880 - 19? (d. Sept. 2, 1966 in Ypsilanti, Washtenaw Co., MI) "Mother", 1853 - 1945 (d. Dec. 13, 1945 in Northville) "Father", 1842 - 1918 (d. Apr. 29, 1918 in Lyon Twp, Oakland Co., MI)
--------------------------------------	---	--

**Lot 22**

**Row 1**

LEADBETER LEADBETER	Susan <i>CALLAHAN</i> Andrew	1849 - 1921 (d. Sept. 30, 1921 in Northville) 1852 - 1921 (d. Dec. 12, 1921 in Northville)
------------------------	---------------------------------	---

**Row 2**

LEADBETER LEADBETER LEADBETER	Cherrie Richard A. Blanche M. <i>WHITEHEAD</i>	1905 - 1994 (d. Jan. 29, 1994 in Farmington Hills, Oakland Co., MI) 1874 - 1952 (d. Aug. 14, 1952 in Highland Park, Wayne Co., MI) 1880 - 1967 (doi 12/19/1967)
-------------------------------------	---	---

**Lot 23**

**Row 1**

WILLIS WILLIS WILLIS	Mark A., Jr. Mark A. E. Mae <i>MUSGROVE</i>	Age 8m, 1922 (d. Oct. 21, 1922 in Ann Arbor, MI) 1886 - 1925 (d. Dec. 27, 1925 in Detroit) 1886 - 1950 (d. Oct. 21, 1950 in Northville)
----------------------------	---	---

**Row 2**

WILLIS WILLIS WILLIS	Betty Jean <i>FINDLAY</i> John C. Sr. John C. Jr.	Dec. 28, 1920 - Oct. 10, 2005 (d. in Stuart, Martin Co., FL) Sept. 22, 1923 - July 15, 1999 (d. in Palm Beach Co., FL) "Son, Brother, Husband, Dad, Papa", Nov. 18, 1949 - June 1, 1997 (d. in Tawas, Iosco Co., MI)
SHEPPARD SHEPPARD	Terri Lynn Phillip John	Feb. 5, 1960 (d. in Detroit at age 0) Apr. 10, 1942 - Dec. 24, 1942 (d. in Northville)

**Lot 24**

BATT	Cletus J.	"Husband", 1905 - 1936 (d. Apr. 25, 1936 in Lyon Twp, Oakland Co., MI)
------	-----------	--

**Lot 21**

No Markers

**Lot 20**

**Row 1**

LAY LEWIS LEWIS	<i>John W.</i> Ettie <i>STEWART</i> William	1883 - 1925 (d. Apr. 6, 1925 in Northville) 1876 - 1943 (d. Mar. 7, 1943 in Royal Oak, MI) 1870 - 1918 (d. June 28, 1918 in Northville)
-----------------------	---	---

**Row 2**

WOODMAN	Harry J.	Mich. Capt, Finance Corps. WW II, Mar. 27, 1919 - Aug. 24, 1967 (d. in Oakland Co., MI)
WOODMAN BRIDWELL	Betty Jane LAY Donald R.	No Marker (d. May 19, 1983 in Royal Oak, Oakland Co., MI at age 60) Mich. 2 Lieut. Air Corps, Foresters of America (metal marker), d. Jan. 29, 1944 (d. in Altus, OK at age 27)

## Section 26

### Lot 20 (continued)

#### Row 3

LEWIS monument

### Lot 17

#### Row 1

GRISWOLD	Abbie Lydia <i>MARCH</i>	1852 - 1918 (d. June 19, 1918 in Northville)
GRISWOLD	Dean F.	1852 - 1946 (d. Oct. 17, 1946 in Northville)
GRISWOLD	Mattie W. <i>WHITE</i>	1875 - 1953 (d. Jan. 3, 1953)

#### Row 2

LOVLEY	John C.	1845 - 1918 (d. Apr. 12, 1918 in Northville)
CHURCH	Jeanne C. <i>CUNNINGHAM</i>	1898 - 1959 (d. Feb. 26, 1959)
CHURCH	Howard E.	1884 - 1952 (d. June 23, 1952 in Parma, Cuyahoga Co., OH)

### Lot 16

SIMMONS	Mildred Irene	No Marker (d. Oct. 17, 1915 in Northville at age 3)
---------	---------------	---

### Lot 13 South

#### Row 1

ROBINSON	Edmund James	1857 - 1934 (d. Dec. 21, 1934 in Detroit)
ROBINSON	Alice M. <i>SAGE</i>	"w/o E. J. ROBINSON", Age 33y, 8m, d. Jan. 7, 1895 (d. in Detroit), plus "A. M. R." footstone

#### Row 2

ROBINSON	Mary D. <i>DEAN</i>	"Mother", Jan. 16, 1835 - July 17, 1935 (d. in Detroit)
ROBINSON	Oscar W.	"Father", Mar. 14, 1831 - Feb. 21, 1902 (d. in St. Johns, Clinton Co., MI)
VERSCHAEVE	<i>Artura Eufrase</i>	No Dates (d. May 6, 1978 in Ann Arbor, MI at age 53)
VERSCHAEVE	<i>Arthur Jerome</i>	No Dates (d. Aug. 5, 1968 in Ann Arbor, MI at age 72)
VERSCHAEVE	<i>Ethelywn R. ROBINSON</i>	No Dates (d. May 20, 1983 in Northville at age 93)

### Lot 13 North

#### Row 1

WITHEE	Warren	"s/o M. J. & M.", 1888 - 1906 (d. July 23, 1906 in Detroit)
WITHEE	Ralph E.	"s/o M. J. & M. L.", Sept. 26, 1881 - Jan. 3, 1891 (d. in Northville)
WITHEE	George S.	1883 - 1929 (d. Mar. 8, 1929 in Ann Arbor, MI)

#### Row 2

WITHEE	Milton <i>John</i>	1855 - 1938 (d. Mar. 9, 1938 in Detroit)
WITHEE	Mary Louise <i>SAGE</i>	1859 - 1924 (d. Jan. 25, 1924 in Birmingham, Oakland Co., MI)

### Lot 12

#### Row 1

WITHEE	John Milton	"Father", Sept. 27, 1819 - Apr. 21, 1886 (d. in Northville)
WITHEE	Mary M. <i>MARTIN</i>	"His Wife, Mother", June 11, 1823 - Dec. 12, 1898 (d. in Northville)
NICOLLS	Milton	"s/o W. C. & L.", 1898 - 1901 (d. Mar. 2, 1901 in Detroit)

#### Row 2

EMERY	Elizabeth	1884 - 1941 (d. July 22, 1941 in Ann Arbor, MI)
unknown	unknown	"1886" footstone

## Section 26

### Lot 9

#### Row 1

CLARK	May B.	"d/o S. & A.", 2y, 7m, 6d, d. Jan. 21, 1878
CLARK	Spencer	1848 - 1934 (d. Sept. 26, 1934 in Northville)
CLARK	Addie Mary <i>WITHEE</i>	1850 - 1948 (d. Feb. 26, 1948 in Northville)
CLARK	Jessie E.	1878 - 1941 (d. Feb. 6, 1941 in Ann Arbor, MI)

#### Row 2

CLARK	Luman	1850 - 1924 (d. Apr. 28, 1924 in Nankin Twp, Wayne Co., MI)
Van VALKENBURGH	Edith <i>CLARK</i>	Eastern Star, "Mother", 1881 - 1974 (d. Jan. 14, 1974 in Garden City, Wayne Co., MI)
Van VALKENBURGH	<i>Charles Raymond</i>	Mason, "Father", 1879 - 1971 (d. Jan. 27, 1971 in Garden City, Wayne Co., MI)

### Lot 8

#### Row 1

LARKINS	Hattie E. <i>SAGE</i>	1857 - 1936 (d. July 27, 1936 in Detroit)
LARKINS	John H.	1848 - 1907 (d. Nov. 15, 1907 in Detroit)
LARKINS	<i>Mary Louise</i>	1885 - 1959 (d. Oct. 22, 1959 in Oakland Co., MI)

#### Row 2

HATCHER	Mabel I. <i>LARKINS</i>	"Mother", 1887 - 1972 (d. Mar. 26, 1972 in Detroit)
HATCHER	Elizabeth	"Daughter", 1914 - 1995 (d. Dec. 28, 1995 in Ozaukee Co., WI)
BALDWIN	Jessie <i>LARKINS</i>	"Mother", 1882 - 1963

### Lot 5

#### Row 1

WALKER	Bessie M. <i>GALBRAITH</i>	1876 - 1917 (d. July 11, 1917 in Northville)
WALKER	John R.	1878 - ? (d. July 14, 1959 in Flint, Genesee Co., MI)
McKAHAN	Julia A. <i>ZIMMER</i>	"w/o Claude J.", 1885 - ? (d. Oct. 20, 1940 in Northville as Julia M. WALKER)
McKAHAN	Claude J.	1881 - 1919 (d. May 29, 1919 in Detroit) (also has a stone in Sec 6)

#### Row 2

ZIMMER	Winifred B. <i>HOPKINS</i>	"w/o A. M. ZIMMER", 1897 - 1925 (d. July 3, 1925 in Northville)
--------	----------------------------	---