

Section 13

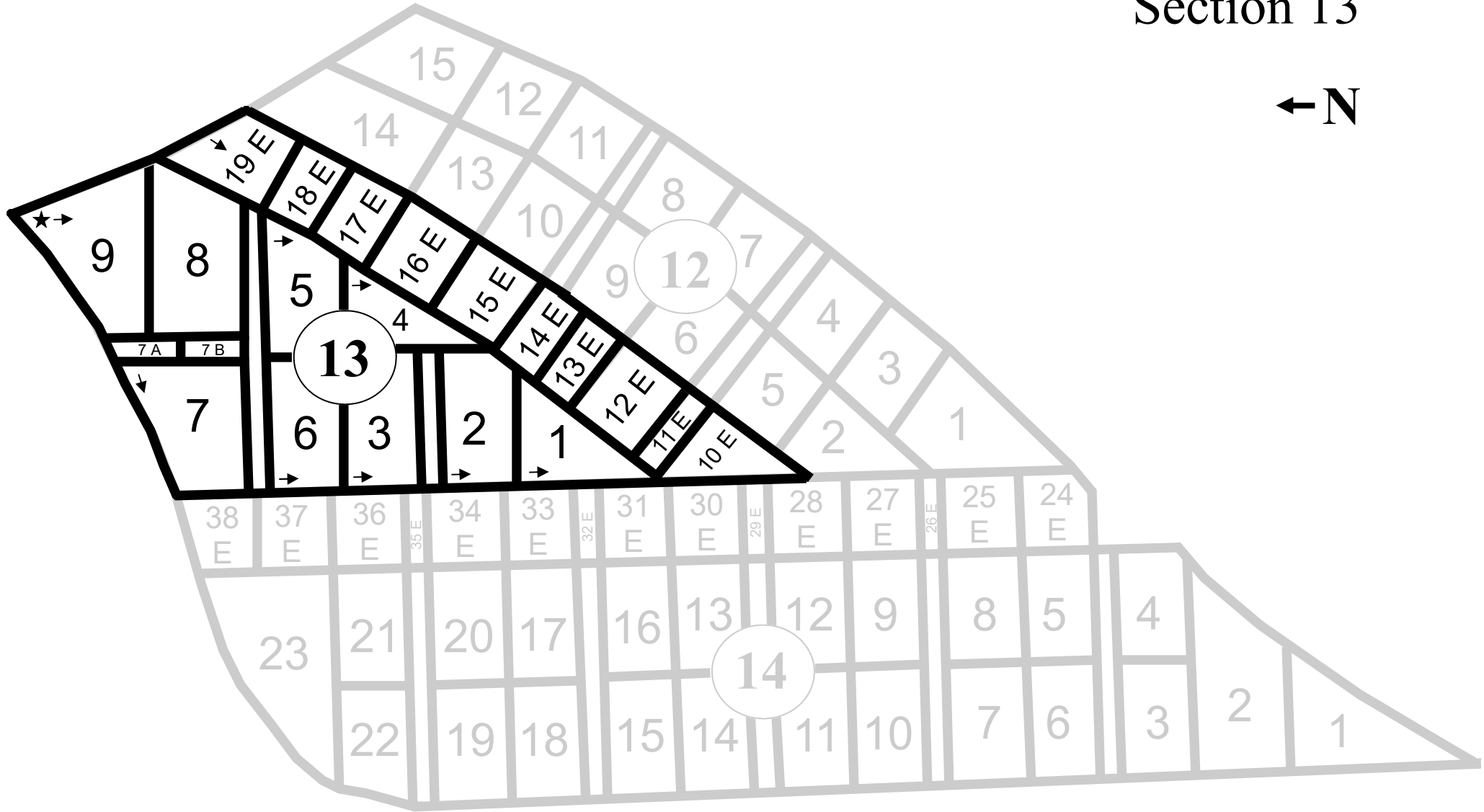

- ★ Start of Section transcription
- ➔ Start and direction of Lot transcription

Section 13
Family Lots

	FAMILY	ACQUIRED BY	DATE
Lot 1	Calkins	H. Clay, LaVern & Mary Lucile Calkins	June 13, 1908
Lot 2	Stark	B. C. & W. H. Stark	Mar. 14, 1907
Lot 3	Dolph	Frank Dolph	May 15, 1907
Lot 4	Kator	James W. Kator	Aug. 30, 1909
Lot 5	Stimpson	Mariah Stimpson	Mar. 18, 1908
Lot 6 West	Thomas	George Thomas	June 21, 1907
Lot 6 East	Postal	Fred W. Like [<i>sic</i>]	Nov. 30, 1908
Lot 7	VanAtta	Jerusha Naylor	Apr. 14, 1900
Lots 8 & 9	Babbitt	Louis A. & Kurnal R. Babbitt	Oct. 31, 1914

Section 13

Lots 9 & 8

Row 1

DAYTON	Dean H.	1934 - ?, "Daughter Paige DAYTON SMITTEN"
DAYTON	Mary Ellen BABBITT REYNOLDS <i>(nee BABBITT)</i>	1928 - 2017 (d. July 4, 2017 in CA), "Children Erik Babbitt REYNOLDS, Marta Ellen EILERS"
BABBITT	Lucie <i>CULLYFORD</i>	"w/o K. R. B.", 1863 - 1937 (d. Apr. 20, 1937 in Manhattan, NY)
BABBITT	Kurnal R.	1864 - 1920 (d. Jan. 24, 1920 in Manhattan, NY)
BABBITT	Louie A.	1861 - 1931 (d. Jan. 3, 1931 in Northville)
BABBITT	Flora W. <i>WAID</i>	"w/o L. A. B.", 1864 - 1951 (d. Oct. 29, 1951 in Northville)
BABBITT	Kurnal <i>Hugh</i>	1898 - 1964 (d. Aug. 16, 1964 in Livonia, Wayne Co., MI)
BABBITT	May H. <i>HOLCOMB</i>	"w/o K. H. B.", 1896 - 1993 (d. Sept. 13, 1993 in Sacramento Co., CA)
BABBITT	Infant	"Infant son of K. H. & M. H.", Jan. 7 - 9, 1927 (d. Jan. 8, 1927 in Detroit)

Row 2

BABBITT	Gloria <i>Virginia</i> CURTIN	Sept. 15, 1925 - Feb. 2, 2015
BABBITT	Louie A. (Col.)	WW II PhM2C AP-54, Korea Lt 7th FB SQ, Vietnam 1131 SA SQ, Dec. 14, 1924 - Dec. 24, 2016 (also has a stone in Veterans section) "Cheryl 1946, Linda 1949, Jack 1957"

Lot 5

Row 1

STIMPSON	Jay D.	1896 - 1921 (d. June 26, 1921 in Northville)
STIMPSON	Carl R.	1889 - 1926 (d. Aug. 11, 1926 in Ann Arbor, MI)

Row 2

STIMPSON	<i>Mabel ATEN</i>	"Mother", 1868 - 1915 (d. Oct. 21, 1915 in Detroit, w/o George STIMPSON)
STIMPSON	William	"Father", 1834 - 1903 (d. Mar. 2, 1908 in Northville)
STIMPSON	Maria L. <i>HURD</i>	"Mother", 1836 - 1918 (d. Apr. 6, 1918 in Tittabawassee, Saginaw Co., MI)

buried elsewhere in lot:

STIMPSON	George W.	No Marker (d. Apr. 10, 1941 in Ann Arbor, MI at age 78)
----------	-----------	---

Lot 4

KATOR	Henry E.	1862 - 1909 (d. Aug. 30, 1909 in Northville)
KATOR	Celia	1854 - 1911 (d. May 14, 1911 in Northville)

Lot 7A

MOYER	Rose EPPENS	No Marker (d. May 3, 1949 in Eloise, Wayne Co., MI at age 63)
-------	-------------	---

Lot 7B

HANNAH	Harold H.	32nd Degree Mason, "Father", 1895 - 1949 (d. Aug. 10, 1949 in Northville)
--------	-----------	--

Lot 7

Row 1

JASKA	Kathleen <i>VanATTA</i>	1903 - 1988 (d. Nov. 25, 1988 in Farmington Hills, Oakland Co., MI)
VanATTA	Don M.	Mason, 1897 - 1932 (d. Dec. 18, 1932 in Detroit)
NAYLOR	George H.	Apr. 30, 1832 - Feb. 3, 1900 (d. in Northville)
NAYLOR	Jerusha <i>MINNOCK</i>	July 31, 1842 - Mar. 21, 1931 (d. Mar. 25, 1931 in Ann Arbor, MI)

Section 13

Lot 7 (continued)

Row 2

HOWARD Karen Kathleen JASKA 1933 - 2004 (d. Oct. 13, 2004)

Row 3

VanATTA Irving Edward "Father", 1865 - 1950 (d. Nov. 19, 1950 in Detroit)
 VanATTA Nora NAYLOR "Mother", 1878 - 1940 (d. June 3, 1940 in Northville)
 VanATTA Roy Maxwell "Married Oct. 10, 1936", "Dad", 1909 - 1982 (d. June 1, 1982 in Northville)
 VanATTA Dorothy Caroline "Mom", 1910 - 2002 (d. Nov. 28, 2002 in Chelsea, Washtenaw Co., MI)
 KIIKEN

Lot 6 West

LYKE Jessie May THOMAS "w/o Fred", 1879 - 1907 (d. Sept. 21, 1907 in Northville)
 THOMAS Isabelle PHILLIPS "w/o George", 1859 - 1907 (d. Sept. 30, 1907 in Northville)
 THOMAS George William No Marker (d. Dec. 24, 1931 in Northville at age 82)

Lot 6 East

POSTAL Alice A. "Mother", Nov. 6, 1861 - Sept. 26, 1912 (d. in Northville)
 SHACKLETON

Lot 3

Row 1

DOLPH Frank A. 1853 - 1924 (d. Nov. 19, 1924 in Northville)
 DOLPH Mary E. MUSGROVE "w/o Frank", 1873 - 1907 (d. Mar. 14, 1907 in Northville)

Row 2

DOLPH George W. 1845 - 1920 (d. Mar. 1, 1920 in Northville)
 DOLPH Rachel Frances 1850 - 19? (d. Sept. 6, 1933 in Franklin, Johnson Co., IN; per DC, buried
 WALKER in Walton, IN)
 DOLPH Catherine S. 1846 - 1920 (d. July 26, 1920 in Northville)
 EVERETT
 DOLPH Samuel B. 1838 - 1918 (d. Mar. 17, 1918 in Northville)

Lot 2

Row 1

STARK Emma COLE 1856 - 1942 (d. June 1, 1942 in Northville)
 STARK Wilbur Henry 1856 - 1943 (d. Sept. 14, 1943 in Northville)
 STARK Eliza COE 1833 - 1919 (d. Jan. 19, 1919 in Northville)
 STARK George W. 1828 - 1907 (d. Mar. 13, 1907 in Northville)

Row 2

STARK Estella P. TOLFORD 1868 - 1950 (d. Apr. 14, 1950 in Northville)
 STARK Bert C. 1865 - 1953 (d. Mar. 26, 1953 in Northville)

Lot 1

CALKINS Ida KATOR 1856 - 1908 (d. June 11, 1908 in Detroit)
 CALKINS Henry Clay 1858 - 1925 (d. Dec. 22, 1925 in Northville)
 JOHNSON Jennie KATOR 1849 - 1913 (d. Dec. 14, 1913 in Northville)

buried elsewhere in lot:

WOODRUFF Mary Lucille CALKINS No Marker (d. Dec. 2, 1945 in San Diego, CA at age ~61)
 WOODRUFF Harry No Marker (d. Sept. 23, 1947 in Lubbock, TX at age 76)

Section 13

Lot 19 E

LAIRD	Iva N. <i>NOWICKI</i>	"Wife, Mother", 1915 - 1962 (d. Nov. 20, 1962 in Detroit)
LAIRD	Fred L.	1914 - 2004 (d. Mar. 13, 2004)
DANCHA	Lynne LAIRD	"Daughter", 1948 - 2015 (d. May 13, 2015)

Lot 18 E

FORD	Madge E. <i>CHASE</i>	1887 - 1961 (d. July 15, 1961 in Northville)
FORD	Thomas C.	1891 - 1976 (d. Mar. 29, 1976 in Port Orange, Volusia Co., FL)

Lot 17 E Northeast Half

CHASE	Ruth Marjory <i>WILLIAMS</i>	1888 - 1967 (d. Apr. 21, 1967 in Northville)
CHASE	Cassalis Mark	1884 - 1950 (d. Aug. 6, 1950 in Michigamme, Marquette Co., MI)

Lot 17 E Southwest Half

CRAIG	Harriet <i>WILLIAMS</i>	1909 - 1963 (d. Oct. 12, 1963 in Livonia, Wayne Co., MI as Harriet RENNER)
CRAIG	Arthur G.	1897 - 1950 (d. Mar. 22, 1950 in Northville)

Lot 16 E

BRUMMEL	Laura <i>RIDENOUR</i>	1901 - 1993 (d. Jan. 5, 1993 in South Lyon, Oakland Co., MI)
BRUMMEL	James J.	1900 - 1970 (d. June 19, 1970 in Wayne, Wayne Co., MI)

Lot 15 E

LeMASTER	Betty E.	No Marker (d. Aug 1998 at age 83; doi 8/15/1998)
LeMASTER	Bertha W. <i>HEAD</i>	1887 - 1965 (d. Aug. 15, 1965)
LeMASTER	Roy V.	Mason, 1890 - 1960 (d. Mar. 12, 1960 in Naples, Collier Co., FL)

Lot 14 E

No Markers

Lot 13 E

NIDD	Alma <i>NEMITZ</i>	"Mother", 1893 - 1996 (d. Dec. 26, 1996 in Sage Twp, Gladwin Co., MI)
MILLER	Ruth A. MATTHEWS (<i>nee HETRICK</i>)	"Wife", 1918 - 2017
MILLER	Jack <i>Newton</i>	Mason, "Husband", 1913 - 1958 (d. July 29, 1958 in Chicago, Cook Co., IL)

Lot 12 E

BERRY	Clara H. <i>RHODES</i>	"Mother", 1874 - 1958 (d. Nov. 11, 1958)
JOHNSON	Clara Lee	Oct. 2-3, 1959 (d. in Detroit)

Lot 11 E

SIMPSON	John	No Marker (d. Nov. 13, 1950 in Northville at age 67)
---------	------	--

Lot 10 E

McDONALD	Leona C. <i>WHIPPLE</i>	"Wife", May 25, 1901 - Aug. 15, 1984 (d. Romulus, Wayne Co., MI)
McDONALD	Ovid <i>Frank</i>	"Husband", Mar. 7, 1901 - May 16, 1971 (d. in Wayne, Wayne Co., MI)
CARTER	Marilyn L.	"Daughter", Oct. 14, 1939 - Jan. 17, 1971 (d. in Farmington, Oakland Co., MI)
CARTER	Eileen B. <i>SHUTTLE</i>	"Mother", July 20, 1915 - Oct. 18, 1970 (d. in Oakland Co., MI)